

NOTES: UNLESS OTHERWISE SPECIFIED

1. SEE DRAWING NO. CB-00290 AND PROCEDURE P-1000 FOR ASSEMBLY AND TEST INSTRUCTION. PROCEDURES AND ASSEMBLY DRAWINGS ARE FOR INTERNAL USE ONLY.
2. ALL TESTING IS PERFORMED IAW BATTERY COUNCIL INTERNATIONAL STANDARDS.
3. DIMENSIONS ARE INCH [MILLIMETER].
4. ABBREVIATION USED IN TITLE IS: SEALED LEAD ACID (SLA).
5. TERMINAL HARDWARE KIT PROVIDED, PART NUMBER 6923.

REVISIONS			
REV	DESCRIPTION	DATE	APPROVED
C	REDESIGNED COVER	12/18/17	PH
D	STANDARDIZED ENVELOPE, ADDED NOTE 5	7/28/20	PH
E	REVISED CONTAINER	12/16/21	PH

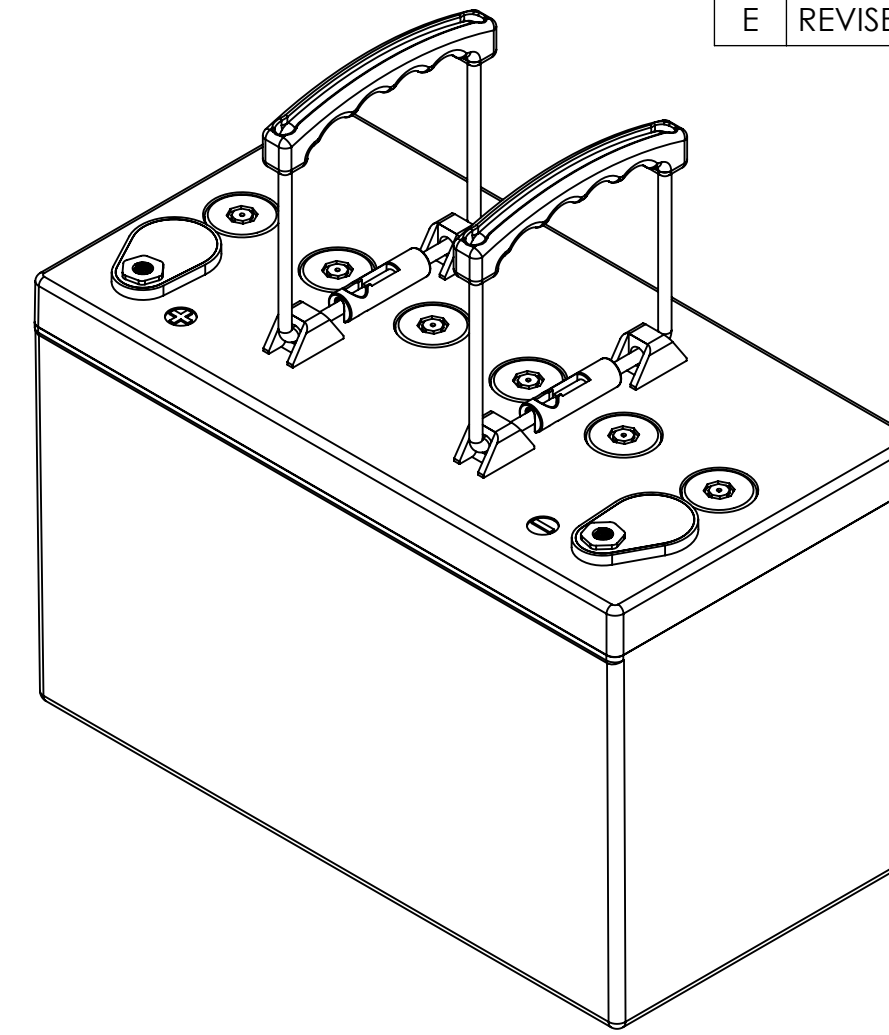
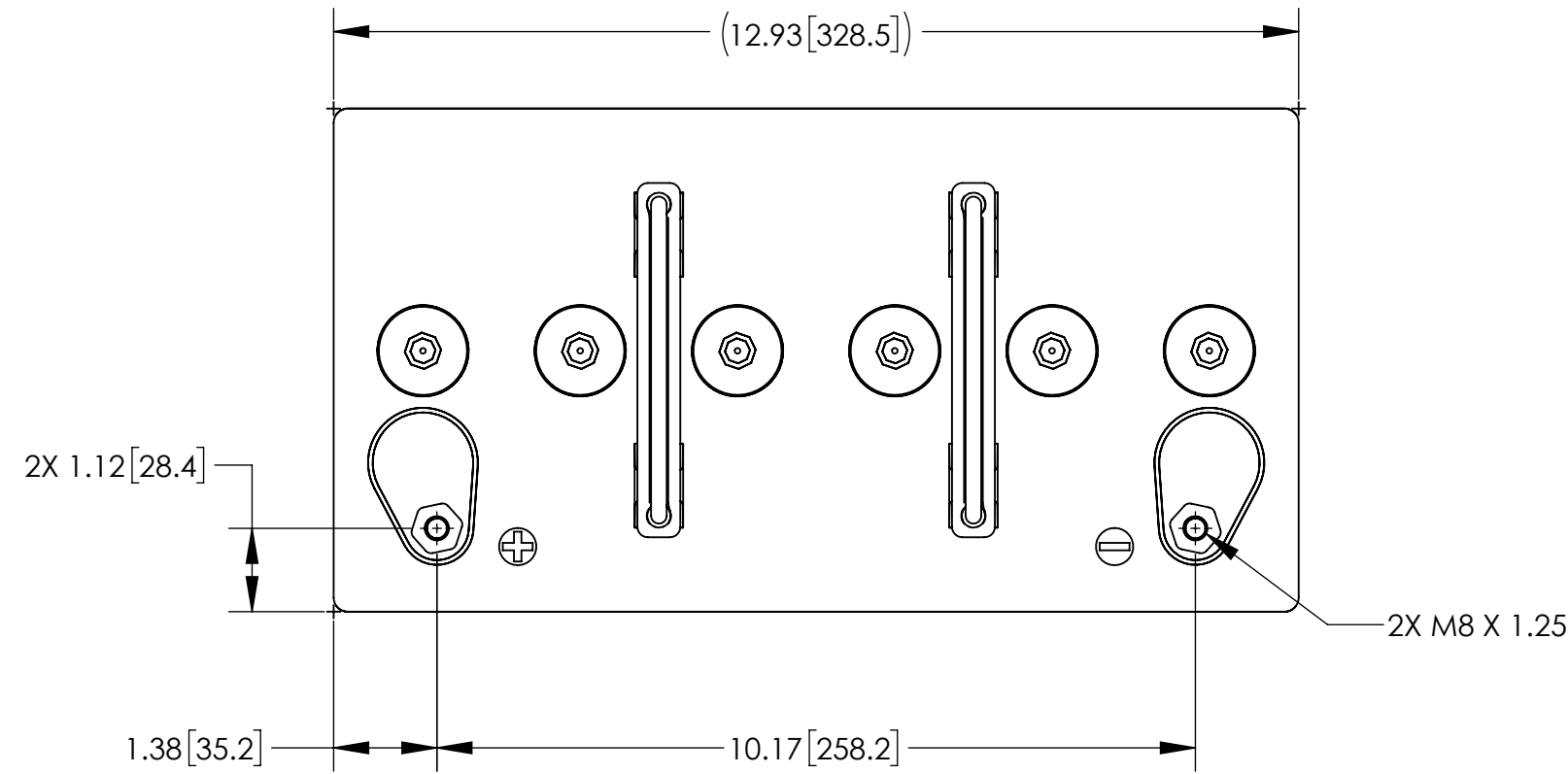

ISOMETRIC VIEW

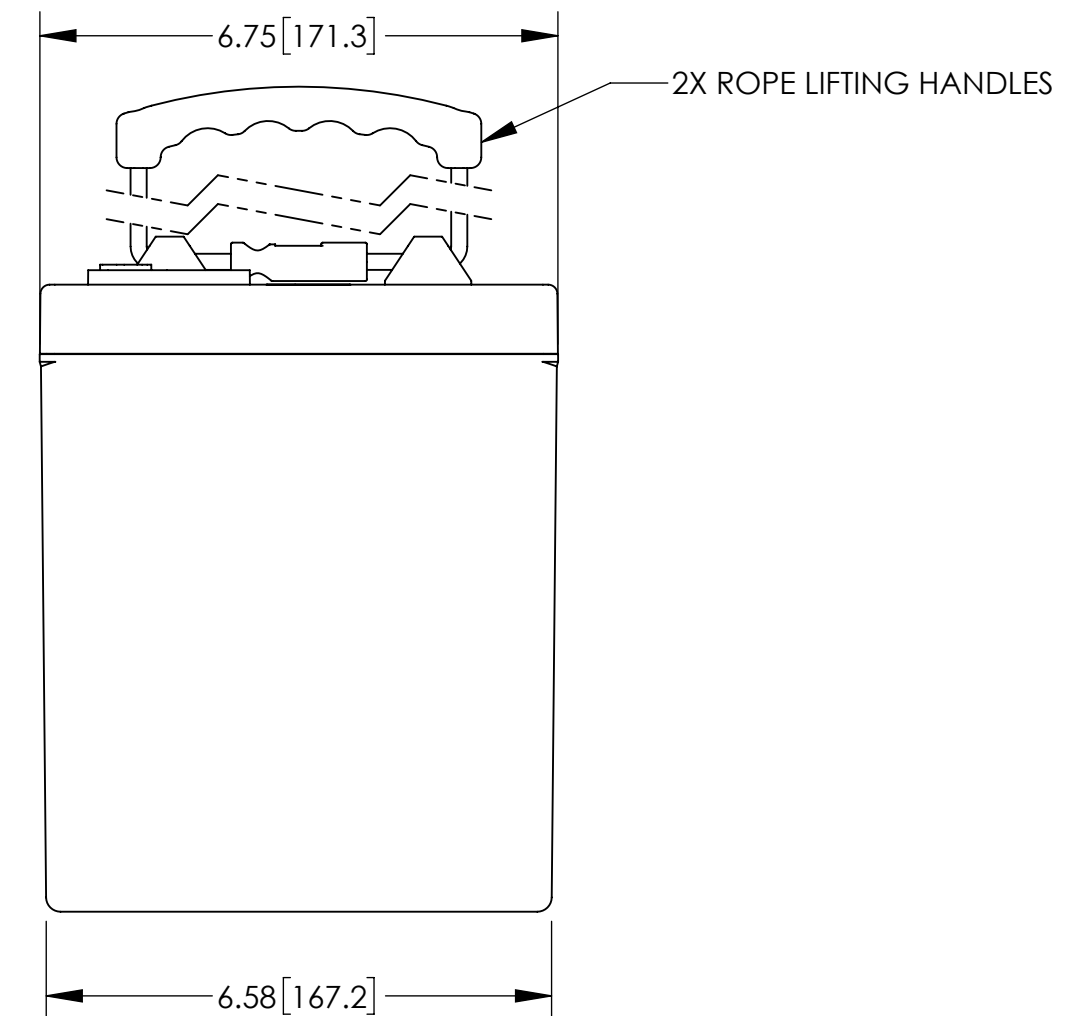
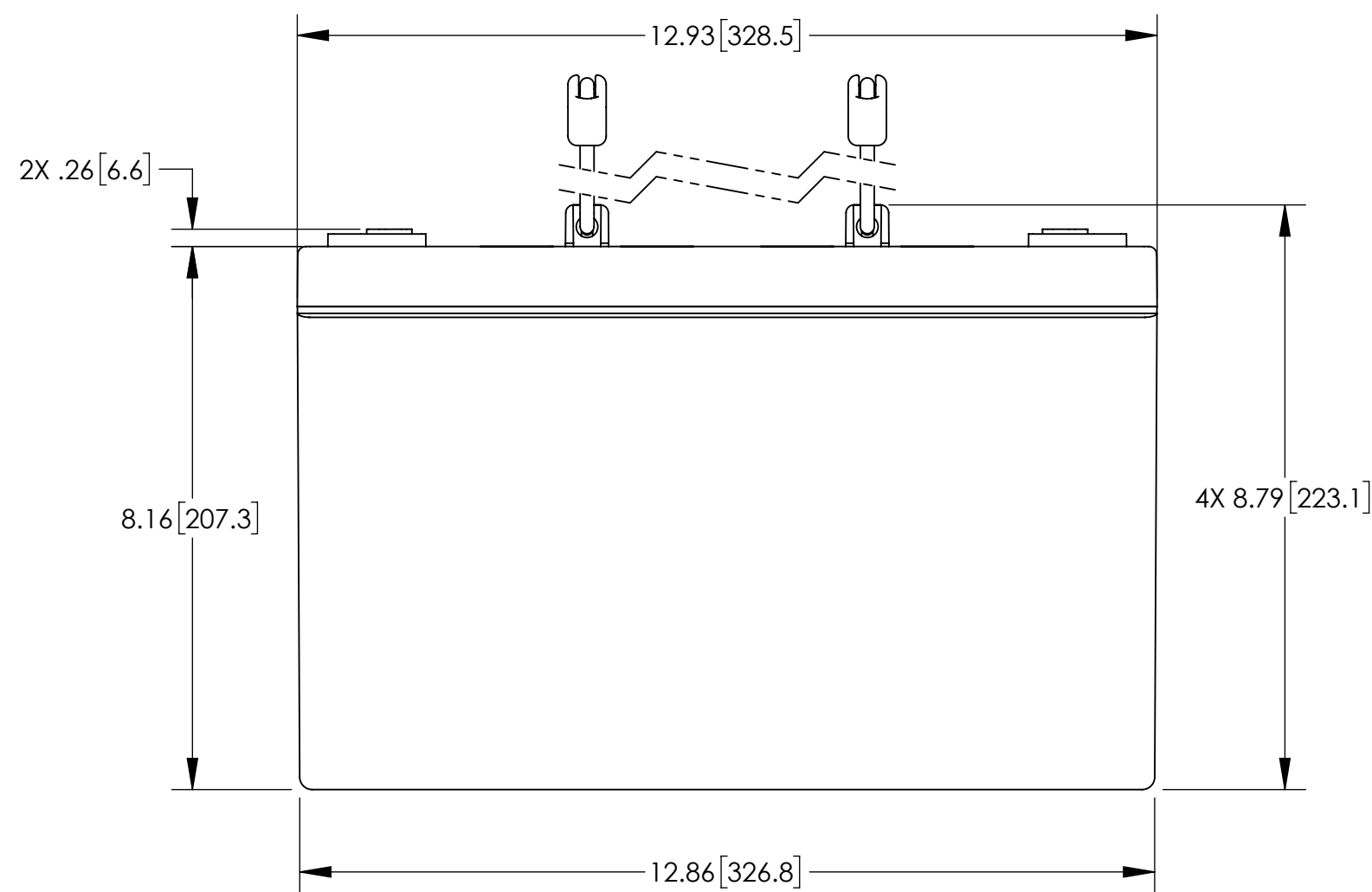

ENVELOPE DRAWING

CAPACITY RATINGS		
PART NUMBER	PVX-890T	PVX-1080T
NOMINAL WEIGHT	62 LBS (28.2 KG)	65 LBS (29.2 KG)
AMPERE HOUR CAPACITY @ 24 HOUR 1.75 VOLTS/CELL @ 77 °F (25 °C)	89 AH	108 AH

UNLESS OTHERWISE SPECIFIED DIMENSIONS ARE IN INCHES TOLERANCES ARE:			CONTRACT NO.		CONCORDE BATTERY CORPORATION 2009 SAN BERNARDINO RD, W. COVINA, CA 91790			
FRACTIONS	DECIMALS	ANGLES	APPROVALS		DATE		TITLE	
±1/32	.XX ± .12 .XXX ± .060	±1°	DRAWN	ELH	8/13/01		BATTERY, SLA, 12 VOLT, PVX-1080T SERIES	
TREATMENT	NONE		CHECKED	HRF	8/21/01		SIZE	REV
FINISH	NONE		APPROVED	JBT	8/23/01		CAGE CODE	E
SIMILAR TO	CALC WT		ISSUED	DH	2/21/22		DWG NO.	
			SCALE		1:2.5		SHEET 1 OF 1	